



PP1-RX4 PROXIMITY READER

INSTALLATION AND MAINTENANCE GUIDE

INFORMATION

GENERAL: The PP1-RX4 mullion style reader is suitable for surface mounting to most plain wall finishes. It is quick and easy to install and is designed for the most demanding access control applications. Capable of reading standard Clock/Data, Weigand and Mifare. Having a slim and innovative clean aesthetic, the reader features an RGB LED with which allows each door to be set with a colour coded access level and to offer illumination for environmental mood lighting or indeed to compliment corporate colours.

CONNECTION: It is recommended that Belden 9536 cable or equivalent is used between the reader and terminal/door controller. Always follow the manufacturers recommendations when connecting to other equipment. IF CABLING IS ROUTED OUTDOORS, UNDERGROUND OR IN DUCTING PRONE TO WETNESS, THE APPROPRIATE CABLE MUST BE USED.

IP+ DOOR	EVOLUTION DOOR	CONNECTION	READER CONNECTOR
+5V	+V	+Vcc	1
C/IN1	C/IN1	DATA I/CLK	2
D/IN2	D/IN2	DATA O/DAT	3
OUT	OP?	GREEN	4
0V	0V	GROUND	8

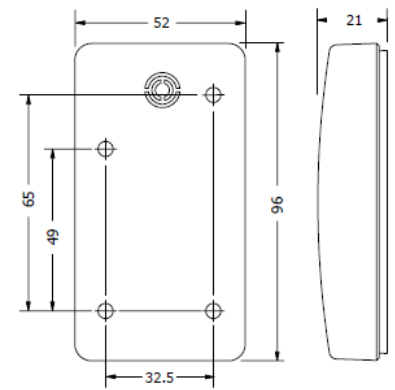

MOUNTING: The PP1-RX4 is designed to be mounted flush to the wall surface. Use the reader mounting bracket to mark out the position of the fixing screws, drill holes suitable for the wall material. When drilling brick material a 6mm drill bit should be used. If mounting on sheet material, glass, metal etc... The mounting arrangements will need to be modified to suit. Drill a hole roughly mid-way between the two mounting holes for the connection cable.

MEDIA: The PP1-RX4 has a read range of up to 15cm. **NOTE:** Reading range can be affected by local installation conditions.

SPECIFICATION:

Voltage:

Operation: +5 Vdc to +16 Vdc
Data Output: Rest >4V dc Active <1V dc

Power Consumption:

Maximum: 250 mA Typical

Dimensions: 96 (L) 21 (H) 52 (W)mm

Mechanical:

Housing: Moulded polycarbonate with fully encapsulated electronics

Mounting: Wall surface

Weight: 115g nominal

Interface: Proximity

Data Output: Mifare/ Wiegand/ Clock Data

Cable Type: Belden 9536

Read Range: Up to 15cm (dependant on media and surroundings)

Environmental:

Operating Temp: -20°C to +60°C

Ingress protection: IP65



HEAD OFFICE

TouchStar ATC
Access | Time | CCTV
Maple Barn,
Beeches Farm Road,
Uckfield,
East Sussex TN22 5QD

T: 0845 3379 155

E: support@touchstar.co.uk

W: www.touchstar-atc.com

REPAIRS

TouchStar ATC
Access | Time | CCTV
Unit 49, Vinehall Business Centre,
Vinehall Road,
Robertsbridge,
East Sussex TN32 5JW